

NEW

EC 1175 MODULAR DESIGN







## Contents

Base unit	1
Infeed table	2
Power options	3
Crane and cabin	4
EC 1175 hooklift/twistlock	5
EC 1175 tracks	6
EC 1175 electro	7

# EC 1175 BASE UNIT

THE NEW EC 1175 EUROPE CHIPPER IS AVAILABLE IN MULTIPLE EDITIONS. EASY CUSTOMIZATION DUE TO SMART MODULAR DESIGN.

## Base unit options

- 1** Base unit for EC 1175 wood chipper, including:
- Drum with 6 knives and 3 or 6 integrated blower paddles for chip discharge
  - Wide infeed opening (1100x750 mm)
  - Automatic no-stress infeed system
  - Hydraulic top infeed roll
  - Hydraulic bottom infeed roll
  - Emergency stop on both sides
  - 50/70/90/110 mm screens
  - Solid steel frame module, integrated in the chipper house
  - Replaceable wearplates along the material flow
  - RAL1007 and RAL7021 coating, custom color is optional

The optional vertical siderolls ensure a perfect and more aggressive infeed when chipping material with voluminous branches sticking out.

- 2** Discharge chute
- The long discharge chute can load the chips into even the highest containers up to 5 meters high at a great discharge range.

- 3** Auger sand discharge
- Excess sand and rocks in the loaded material will be reduced significantly with the overlap between the infeed table and infeed of the chipper. Unwanted material will be transported through the auger system to the blower, which keeps your working grounds neat and clean. This system also increases lifetime of your knives and therefore your production capacity.

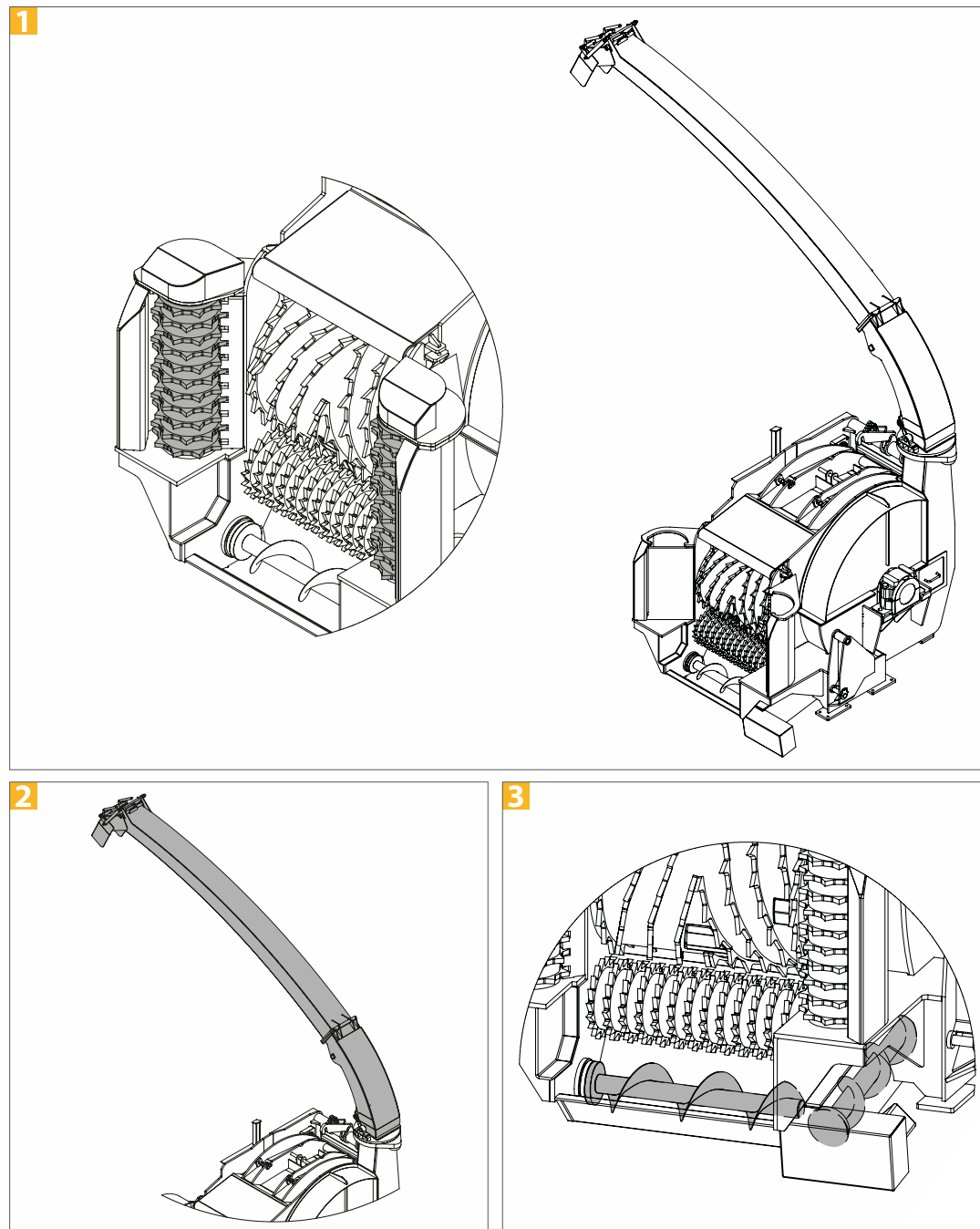

## EC 1175 INFEED TABLE

THE EC 1175 CAN BE CONFIGURED WITH A VARIETY OF INFEED OPTIONS. CHOOSE BETWEEN THE FOLDABLE CHAIN INFEED TABLE AND THE STATIONARY EXTENDED TABLE.

### Infeed table options

- 1** 180° foldable chain infeed table.  
This infeed creates the possibility for side-feed and stays within 2,5m width to still be roadlegal.
- 2** Optionally, the stationary chain infeed table can have double the standard length and offers the best choice for industrial purposes, like chipping slabs, logs and brushwood.
- \*** The triple open infeed chain sorts out sand and rocks and improves lifetime of wearparts inside the chipper.

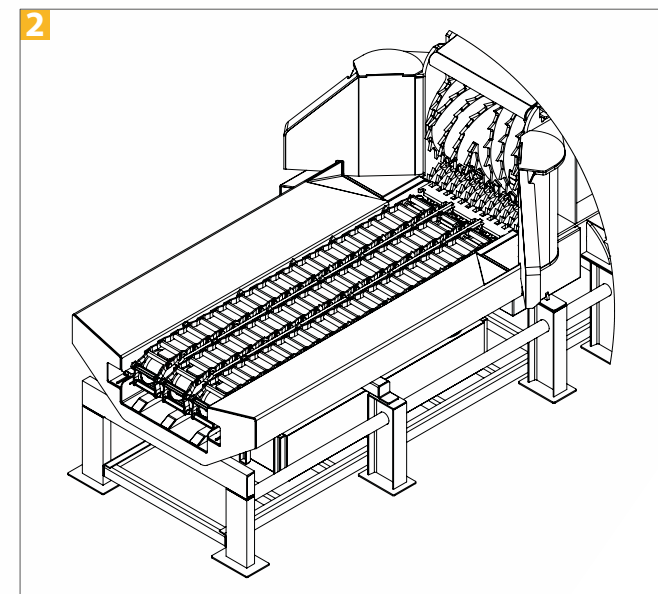
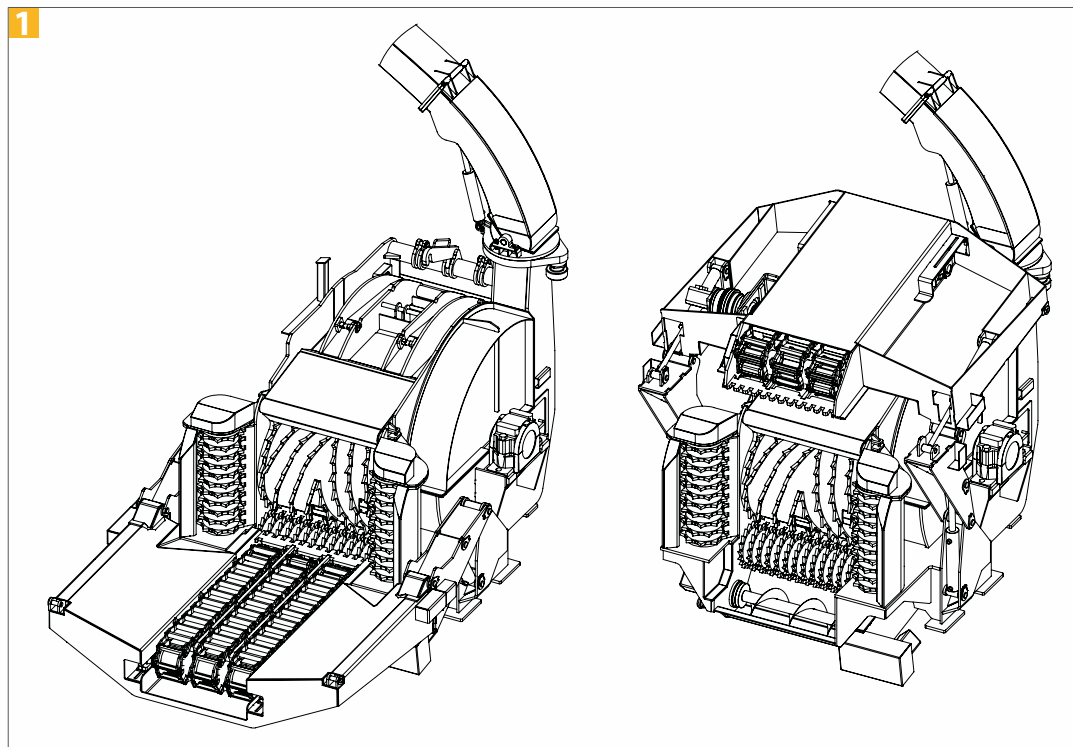

## EC 1175 DRIVE TRAIN OPTIONS

THE EC 1175 CAN BE EQUIPPED WITH THE LATEST C13 CATERPILLAR ENGINE, RATED TIER 4 FINAL. THIS ENGINE IS DESIGNED TO MEET THE BEST FUEL EFFICIENCY, LOWEST OPERATING COSTS AND TOUGH EMISSIONS STANDARDS.

### Engine options

- 1** Diesel engine drive.  
Caterpillar C18 Tier 3  
6 in-line diesel engine  
800 horsepower @ 2000rpm  
Parallel twin-turbo  
Hydraulic clutch
- 2** Diesel engine drive.  
Caterpillar C13 Tier 4 Final  
6 in-line diesel engine  
440 horsepower @ 2000rpm  
Turbocharged Aftercooled  
Hydraulic clutch

Optional a Flexxaire reversing fan can be installed, which keeps your radiator clean, maximizes engine performance and saves fuel.

- 3** Electro drive.  
Electromotors in the range from 315kW up to 560kW can be equipped. This package includes a powerpack for all hydraulic infeed and cylinder functions.

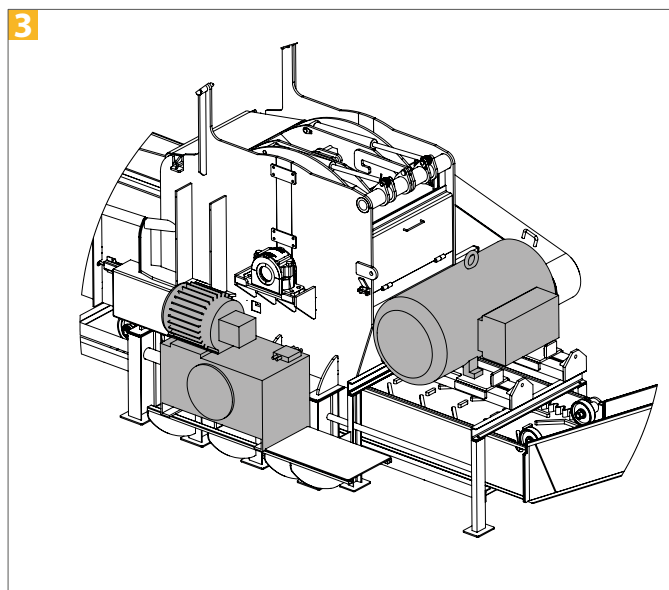
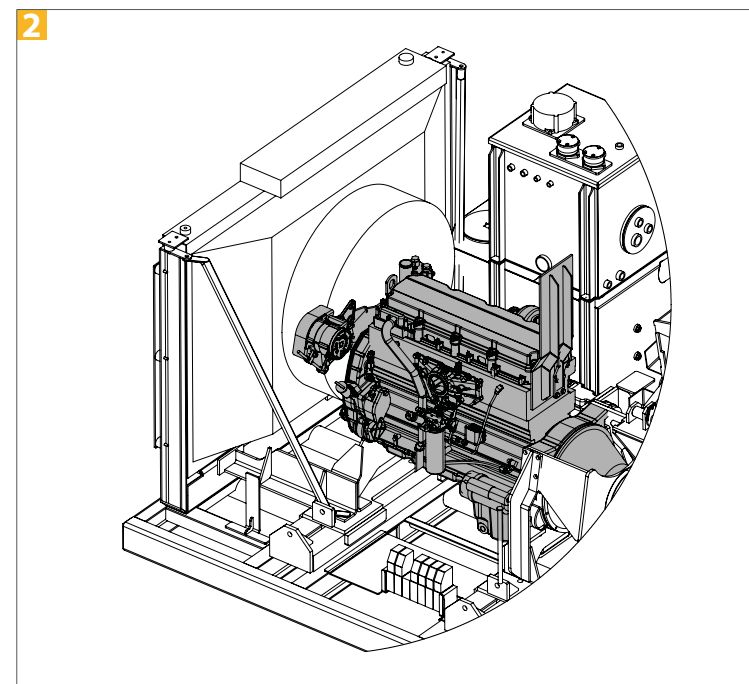
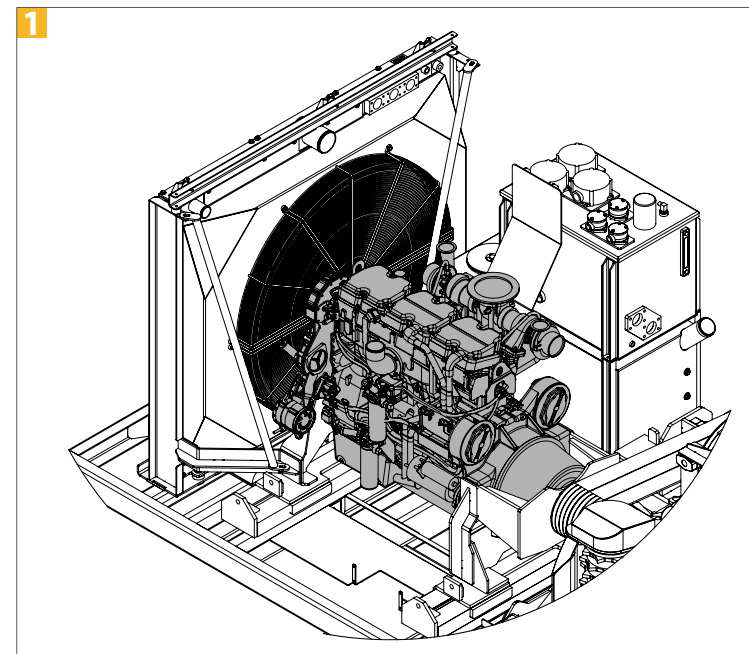

# CRANES AND CONTROLLERS

THE EUROPE CHIPPER CAN BE FITTED WITH A CRANE TO YOUR LIKING. WE OFFER SEVERAL BRANDS AND EVERYTHING FROM SMALL TO THE BIGGEST CRANES WITH FULLY EQUIPPED CABINS.

## Options for cranes and controllers

- 1 Wide range of Europe Forestry cranes, manufactured by Palfinger. They range from 4 tonnes and outreach of 6.5 meters. up to 10 tonnes and outreach of 9.7 meters.

Multiple wood grapples are available, ranging from 4 to 9 tonnes with a maximum opening of 1480 to 2030mm.

- 2 Optional cabin to comfortably load the Europe Chipper. The cabin can be configured to personal preferences:

- 7 section (6 crane, 1 cabin lift) control valve manually operated
- Radio with RDS / CD and Line In for MP3 player
- Front and side door with 8mm safety glass
- Seat heating
- 5 work lights and indoor lighting
- Windscreen wipers
- 12 Volt socket for mobile phone charger
- Comfortable chair with suspension
- Diesel heater or heating from engine based coolingwater

Optional:

- Support legs in various designs
- Load sensing valve

- 3 EC1175 on tracks, equipped with a 10 ton, 9.6 meter crane in combination with a fully equipped cabin.

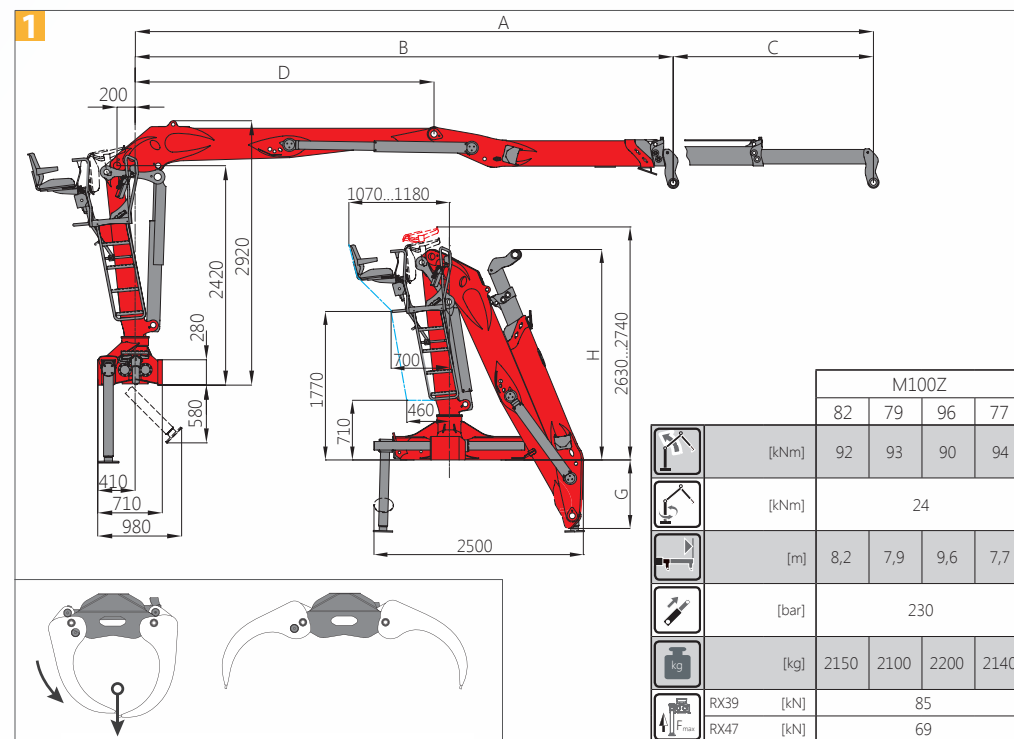



## EC 1175 HOOKLIFT/TWISTLOCK

THE EC 1175 IS THE NEW PREMIUM MODEL IN THE EUROPE CHIPPERS LINE-UP. THIS VERSION IS PRESENTED WITH A HOOKLIFT OR TWISTLOCK SYSTEM FOR EASY LOADING ONTO TRUCKS.

### EC 1175 details

- 1 The automatic chain infeed table makes the infeed process easy and extremely efficient. With the open infeed chain you sort out sand and rocks and improve lifetime of wearparts inside the chipper.
- 2 The long discharge chute enables you to load even the highest containers at a great discharge range.
- 3 This EC 1175 is equipped with a Caterpillar C18 engine. This generates enough power to chip logs up to 70cm.
- 4 The hooklift version is easy to load onto any truck with a hooklift system and stays within 2.5m width and 4m height to still be roadlegal. Dismount your chipper from the truck and load a container for maximum efficiency!
- 5 The twistlock system is a well-known method of securing cargo onto transport vehicles. With a twistlock on every corner, the EC 1175 stays secure when chipping.

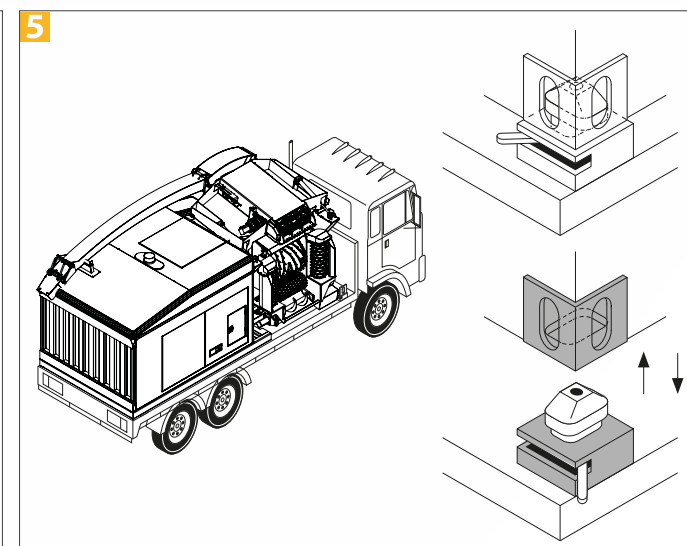
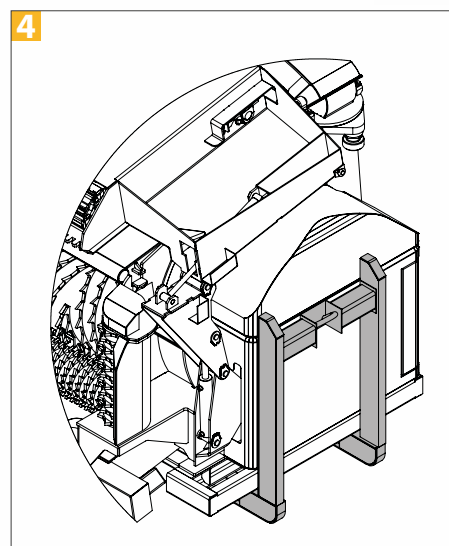
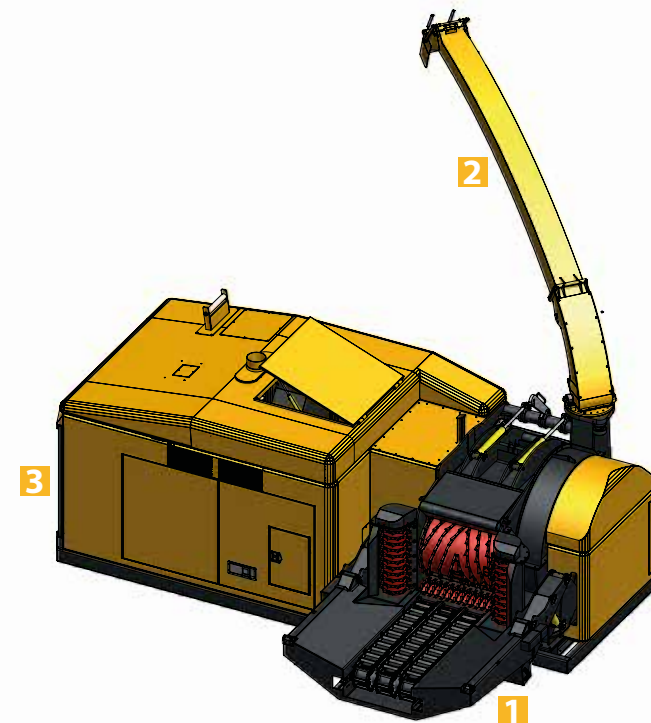
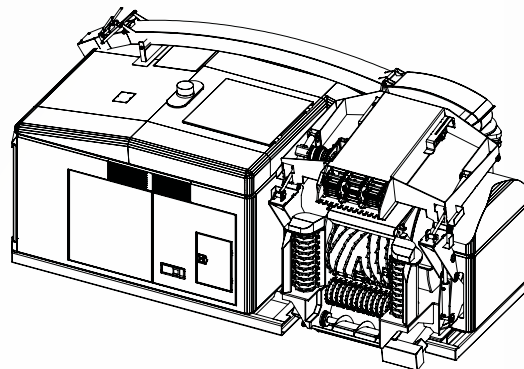
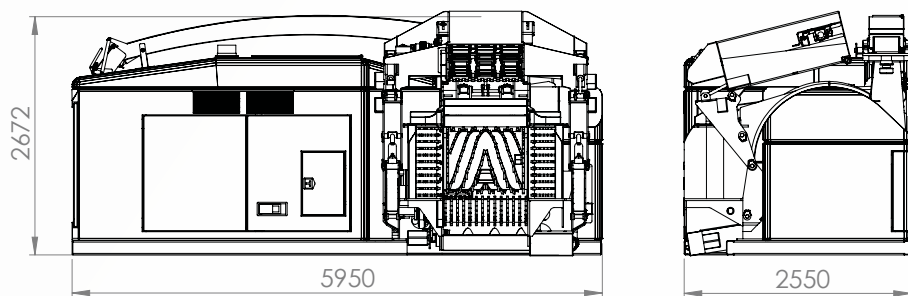



## EC 1175 TRACKS

THE EC 1175 IS THE NEW PREMIUM MODEL IN THE EUROPE CHIPPERS LINE-UP. THIS VERSION IS FITTED WITH 600MM WIDE TRACKS FOR THE MOST RUGGED TERRAIN AND IS SELF-SUPPORTING IN COMBINATION WITH THE 10 TONS CRANE.

### EC 1060 details

- 1** The standard steel tracks can be fitted with rubber pads for maneuvering on concrete floors without damage. Controlling the tracks can be done by remote control.

With an electronic valve the tracks switch between the low- and high gearing.

- 2** The EC1175 is normally equipped with a Caterpillar C13 Tier 4 Final engine. Optional a Caterpillar C18 Tier 3 engine can be mounted, with 800hp.

- 3** This edition is equipped with a crane with 9,6m hydraulic range and a maximum carrying load of almost 10 tons!

The crane and cabin can rotate 360 degrees and can lift 1100mm for the most optimal overview while working.

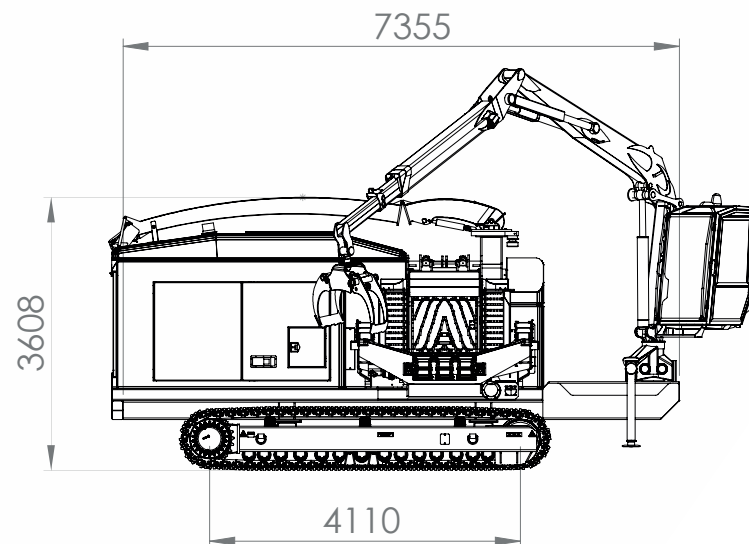
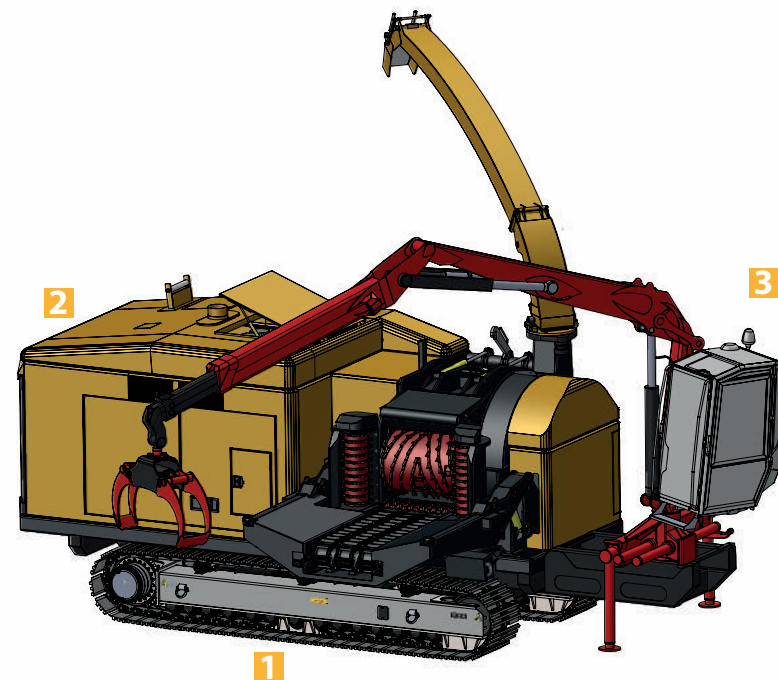
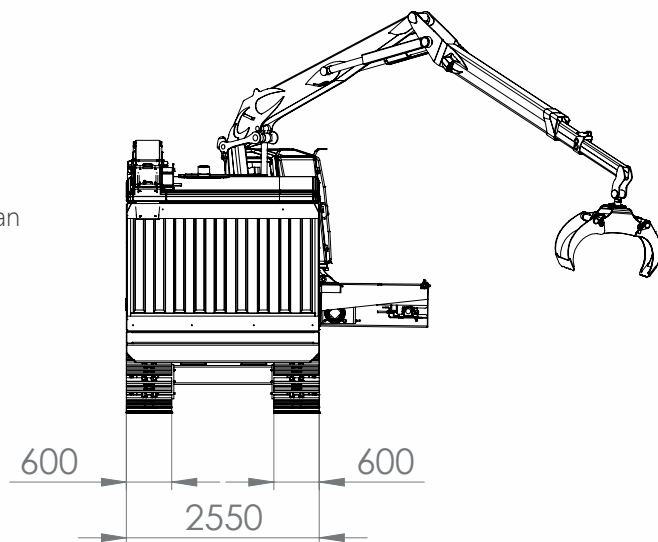

## EC 1175 STATIONARY ELECTRO

THE NEW EC 1175 EUROPE CHIPPER CAN ALSO BE CONFIGURED AS A STATIONARY MACHINE WITH AN ELECTRO POWER UNIT. THIS IS AN EXCELLENT CONFIGURATION FOR INDUSTRIAL PURPOSES.

### Electro edition details

- 1** Choice of power is up to the customer, the range of motors starts at 315kW and goes up to 560kW. This package includes a powerpack for all hydraulic infeed and cylinder functions.
- 2** An optional discharge conveyor provides the best quality chips with minimal dust production.
- 3** The optionally extended infeed table provides constant supply of material. Excellent for industrial purposes and chipping of slabs, logs and brushwood.
- 4** The hydraulic powerpack provides the oilflow for all infeed and cylinder functions.

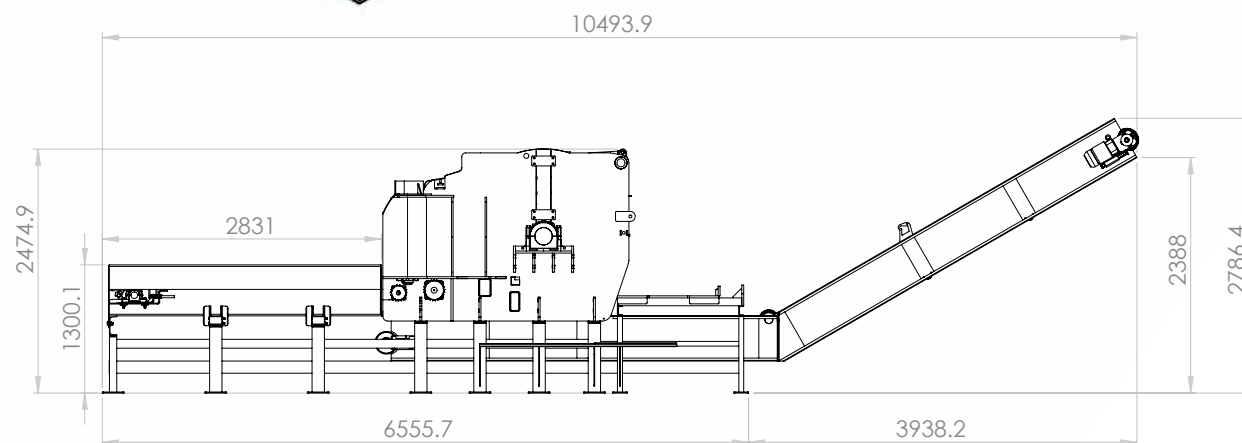
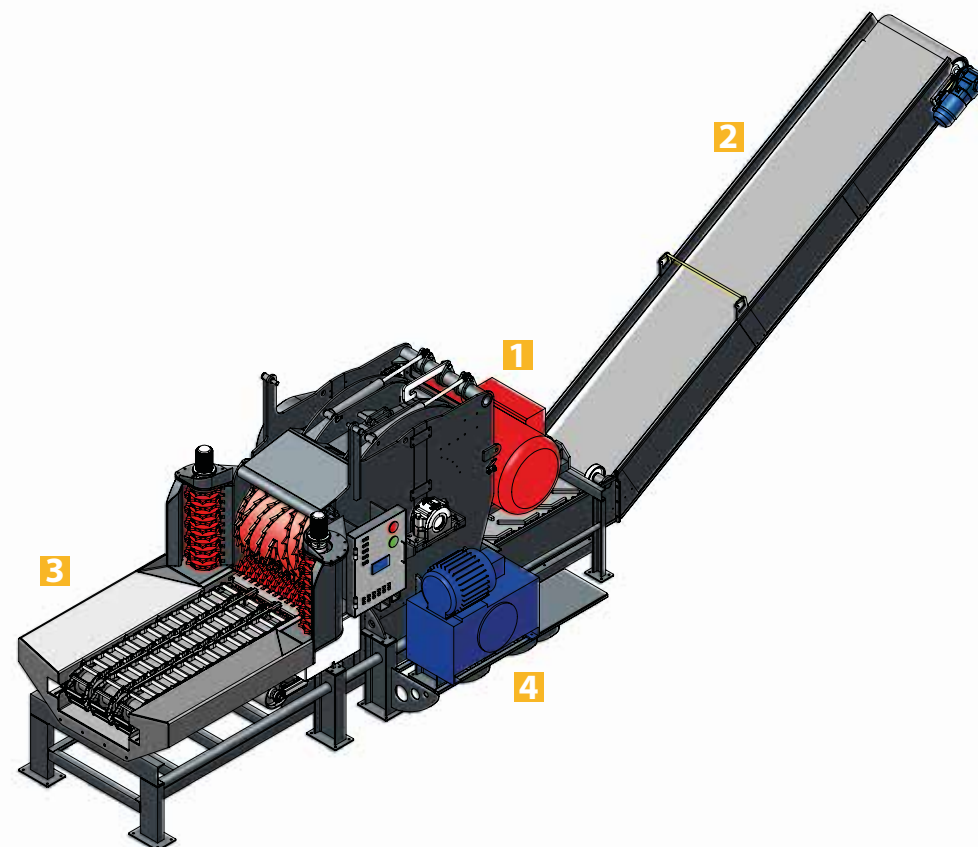
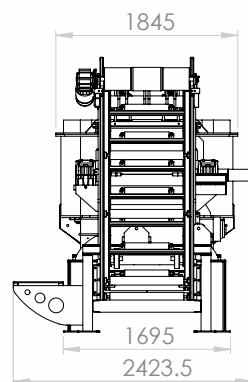





DEALER

